

This drawing and design is protected by copyright and the information is confidential. It is also protected and registered under Dutch laws through the Dutch government department for taxes. The drawing and/or models may not to copied, reproduced, duplicated or disclosed to others, in whole or in part without prior written consent of Rob Snel B.V./the Netherlands

TOP-VIEW

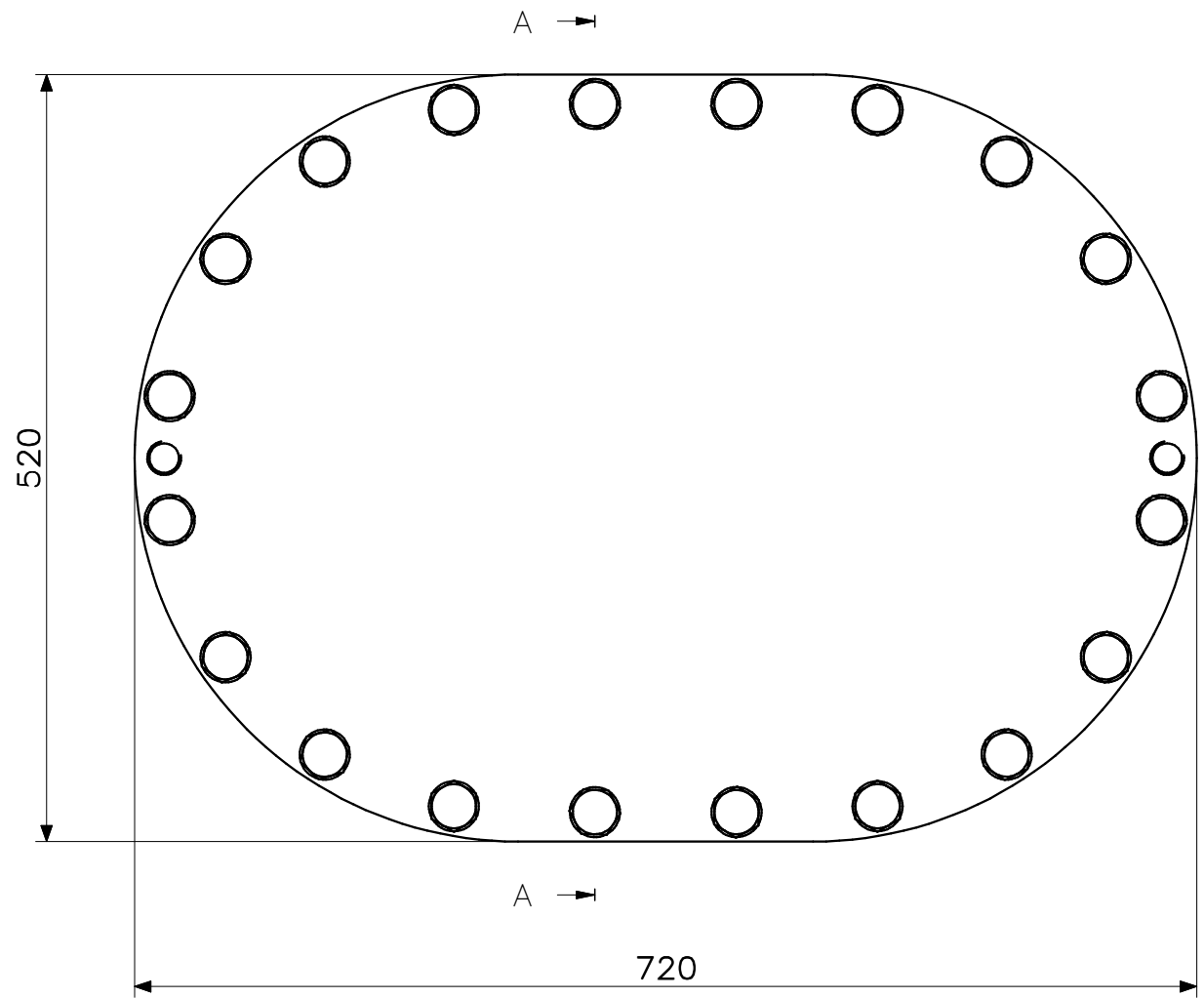

SECTION A-A

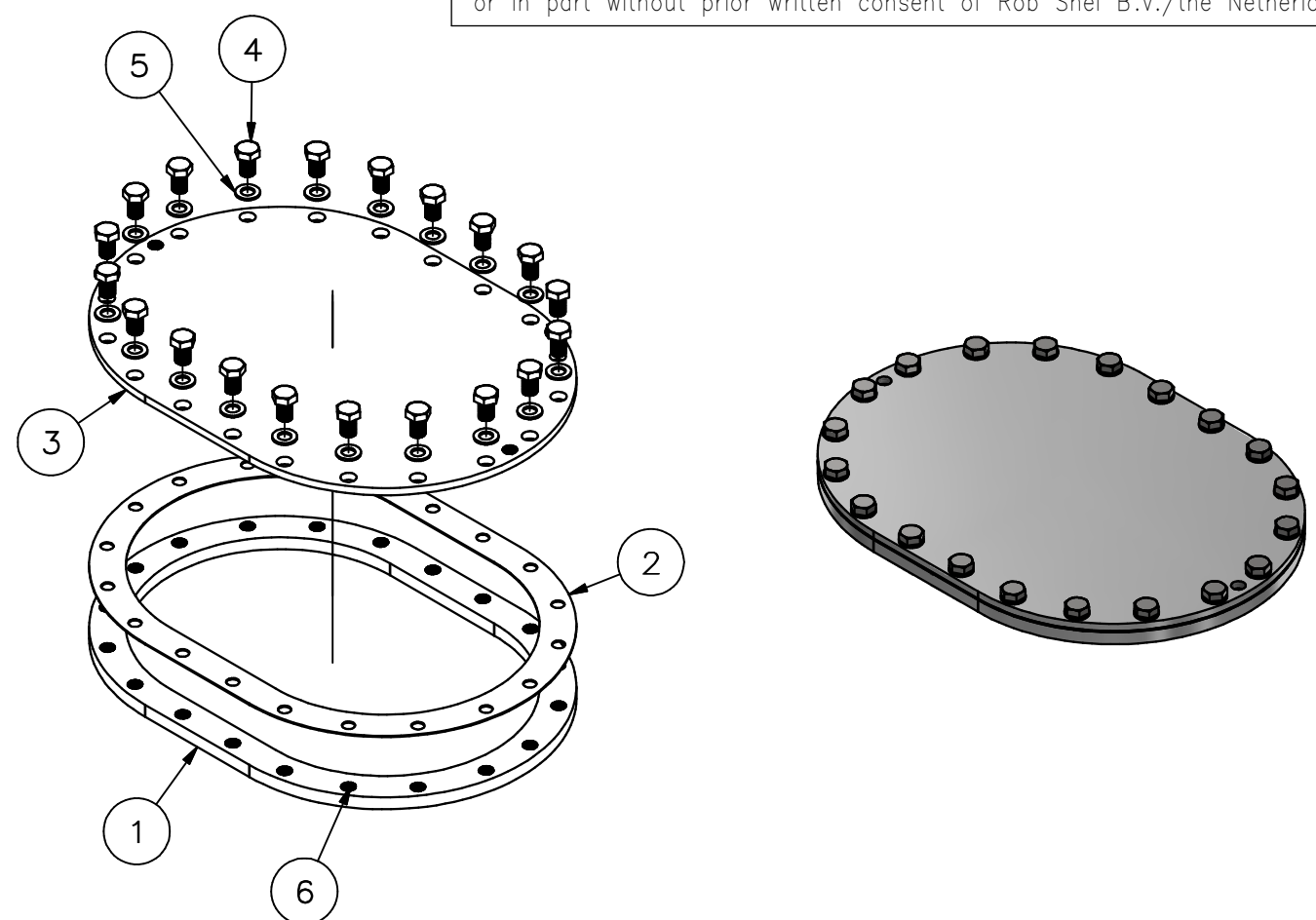
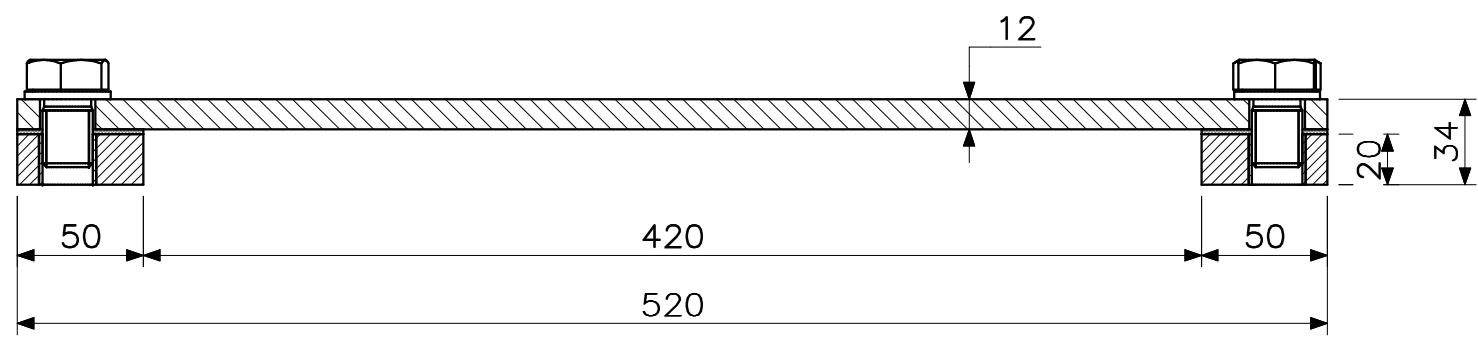

3D-IMPRESSION - EXPLODED VIEW

6	20	Helicoils M20x20	Stainless Steel	M20x20	52.AL.524.06
5	20	WASHER RVS DIN125 M18	Stainless Steel	Washer	18.SS.920.18
4	20	Hex-Head Bolt M20x30	Stainless Steel	DIN 933 - M20 x 30	52.AL.524.06
3	1	Manhole Cover	Aluminium	720x520	52.AL.524.06
2	1	Seal	Nitril	DIN 83403-A	52.AL.524.06
1	1	Manhole Ring	Aluminium	720x520	52.AL.524.06
POS	QTY	TITLE	MATERIAL	DIMENSION	DWG NR

C		
B		
A		

Rev.: REV. DATE: REVISION SUBJECT

Date:	4-7-2023	 <p>Rob Snel TECHNISCHE GROOTHANDEL</p>	Rob Snel Technische Groothandel Industrieweg 39 3361 HJ Sliedrecht T +31 (0)184 43 30 30 F +31 (0)184 43 30 31 E s.snel@robsnel.nl I www.robsnel.nl	Art.nr:
Drawn:	Hans Baars			Projection type:
Scale:	1:5 1:3			
Status:	Pending			
Cust.:				
Project:				

Title: Aluminium Manhole C/O 620x420 - Type A-Oval

Mat:	Dwg.nr:	Revision:	Sheet:	Format:
	52.AL.524.06		1	A3